

GENERAL NOTES

1. OBSTRUCTIONS
 - (a) All obstructions marked * to be removed or relocated by others.
 - (b) All obstructions marked + to be removed under this contract
 - (c) All obstructions marked o to be relocated under this contract as directed by the Engineer.
2. DRIVEWAYS
 - (a) Driveways Marked I: All driveway paving shall be removed from the public right of way, and said driveways shall be closed as directed by the Engineer.
 - (b) All Other Driveways: Existing paving (including sidewalks in the driveway area) shall be removed to a "line 36 ft. north or south of the 4' of 2nd St. Driveways shall be reconstructed the width indicated in brackets [] on the plan between said line and the "curb to be constructed". Sidewalks shall be removed east and west to the nearest score marking beyond the driveway boundaries and replaced back to the newly constructed driveways. Commercial driveways or driveways, where the new curb face exceeds 0.67 ft. shall be removed and reconstructed back to the property line.
3. INTERSECTIONS
 - (a) Paving: All existing pavement in the area shown thus in plan shall be removed and replaced with 2 1/2" P.M.S.
 - (b) Curb & Gutter: All existing P.C.C. curb & gutter at Sierra Way and at the Alley shall be removed. At Allen St., Cuttle Dr., and Lugo Ave. the existing P.C.C. curb or curb & gutter shall be removed to the first score marking beyond the end of the "curb returns to be constructed" and reconstructed back to smoothly join the new curb returns.
 - (c) Sidewalks: All existing P.C.C. sidewalks within the "curb returns to be constructed" shall be removed back to the beginnings and endings of said curb returns. Sidewalks shall be reconstructed in sidewalk areas shown thus in plan.
4. MANHOLES
 - All manholes shall be adjusted to grade.
5. SPECIFICATIONS
 - All work embodied on these plans shall be done in conformity with applicable provisions of Specifications No. 2232.
6. LEGEND
 - D/W means Driveway
 - P.M.S. means Bituminous Plant-Mixed Surfacing
 - P.C.C. or Conc. means Portland Cement Concrete
 - M.H. means Manhole
 - WG means Water Gate

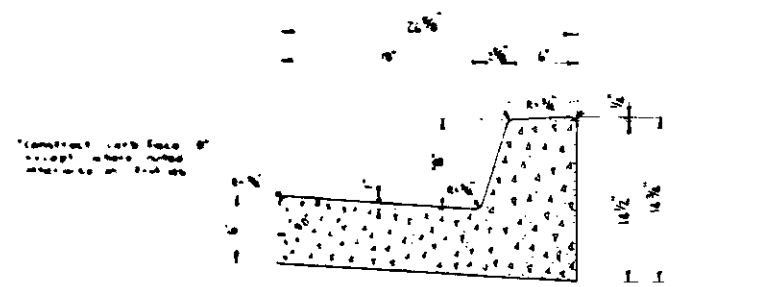

TYPICAL SECTION ~ P.C.C. CURB & GUTTER
SCALE 1 1/2" = 1'

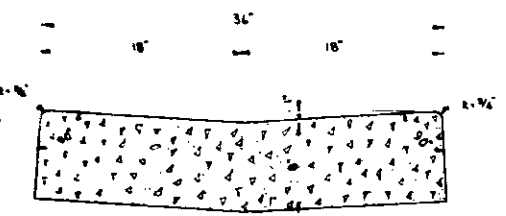

TYPICAL SECTION ~ 3' P.C.C. CROSS GUTTER
SCALE 1 1/2" = 1'

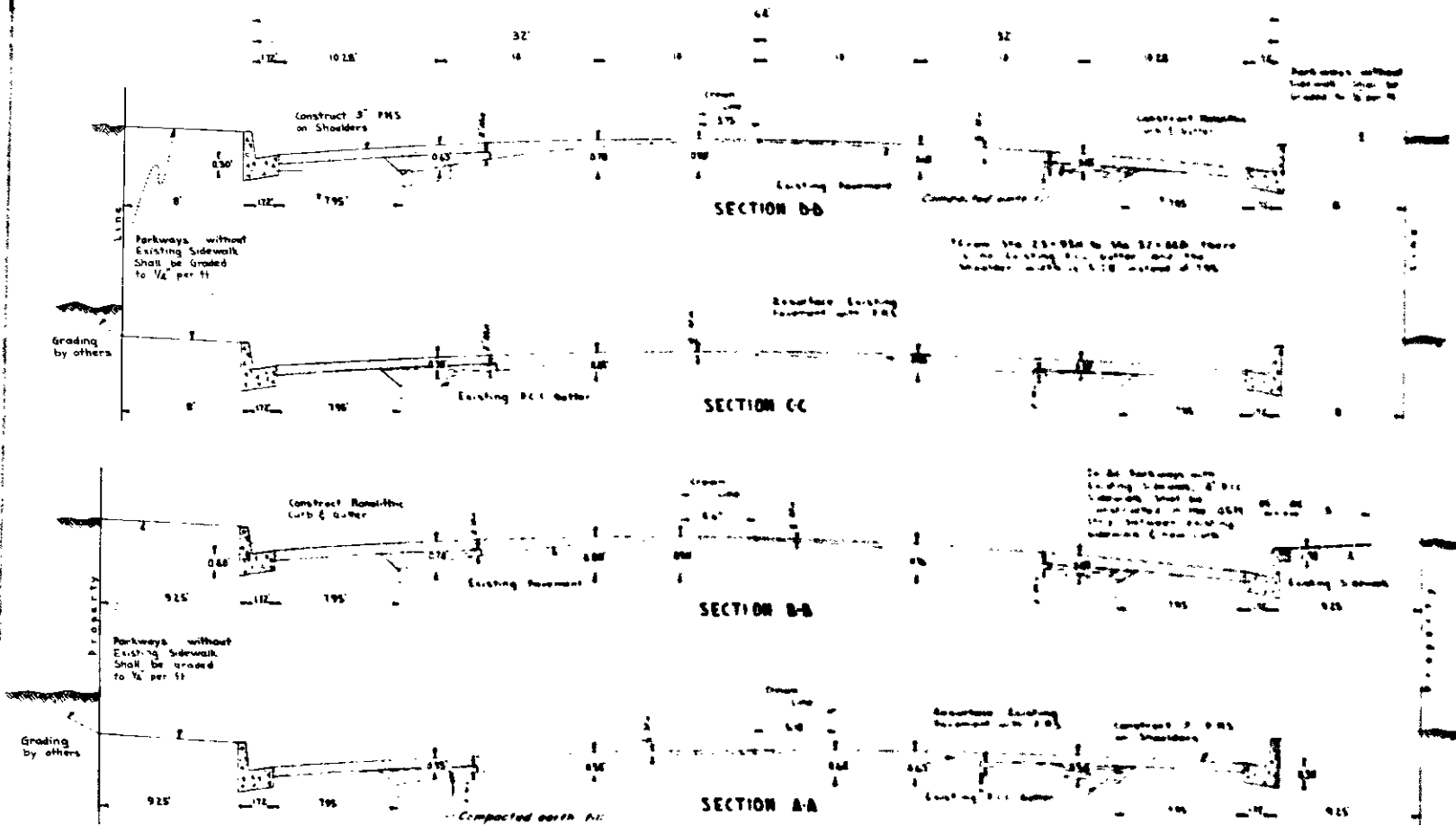

TYPICAL SECTIONS
SCALE: VERT 1/2" = 1'

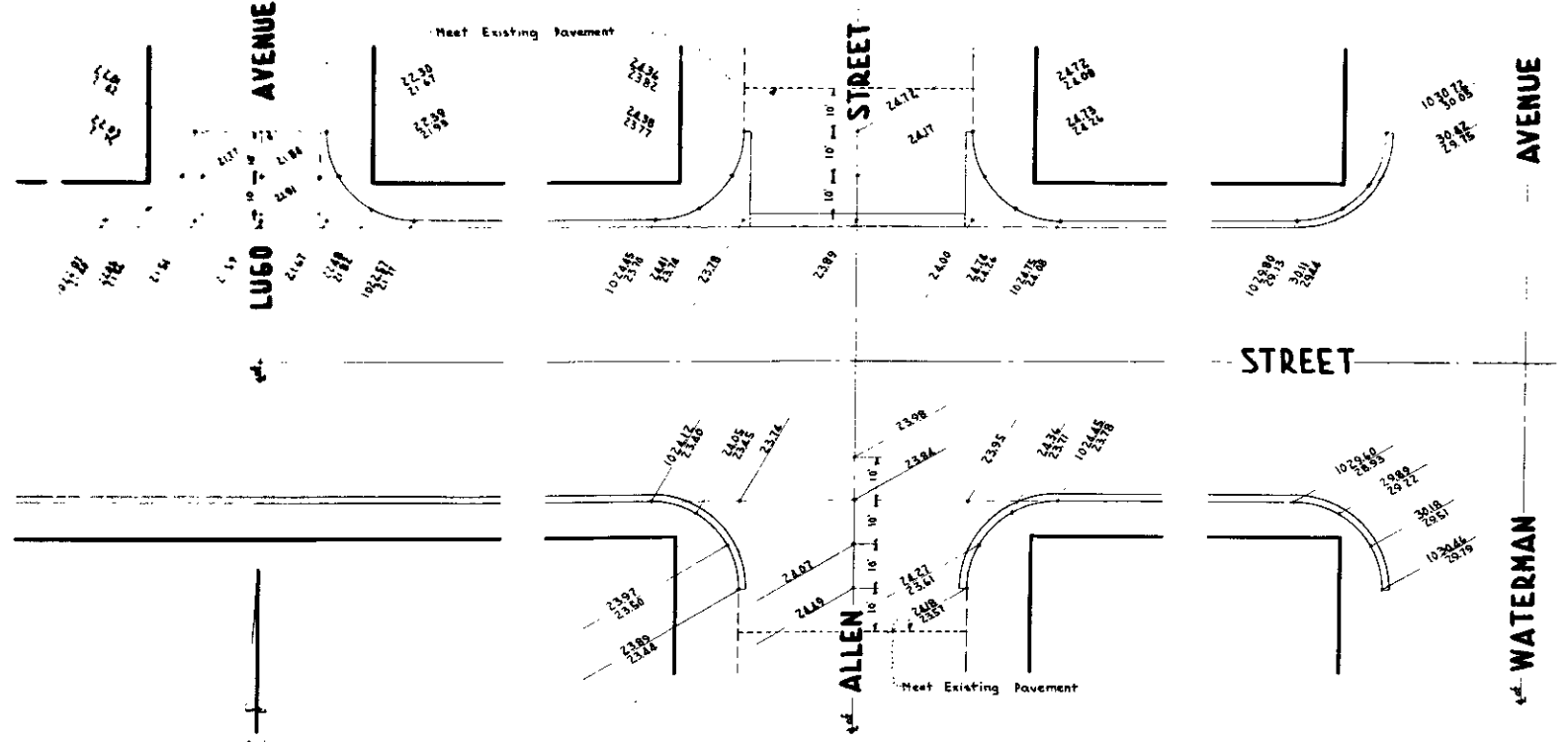
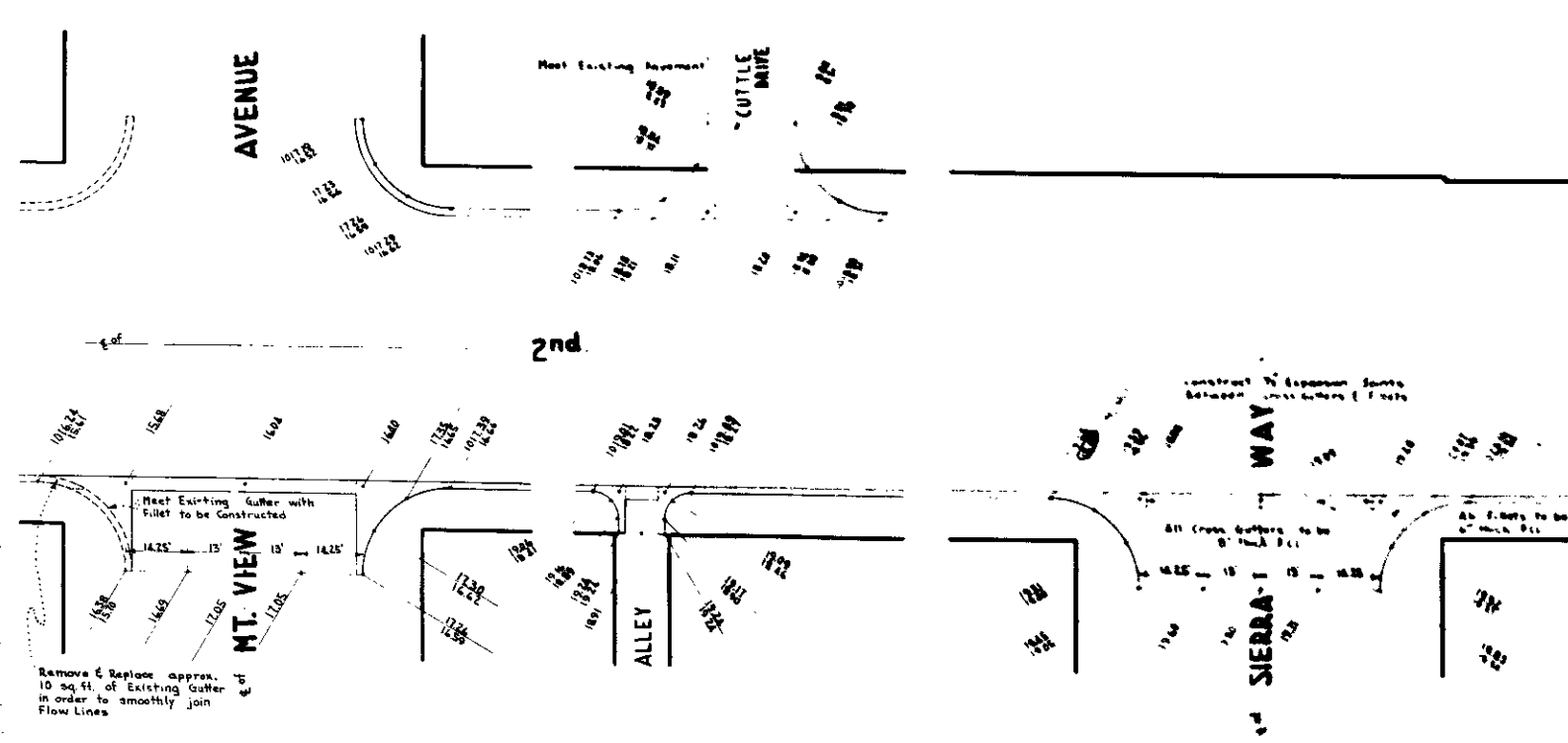

INTERSECTION LEVELS
SCALE ~ 1" = 20'

GENERAL NOTES

1. OBSTRUCTIONS
 - (a) All obstructions marked * to be removed or relocated by others.
 - (b) All obstructions marked + to be removed under this contract
 - (c) All obstructions marked o to be relocated under this contract as directed by the Engineer.
2. DRIVEWAYS
 - (a) Driveways Marked I: All driveway paving shall be removed from the public right of way, and said driveways shall be closed as directed by the Engineer.
 - (b) All Other Driveways: Existing paving (including sidewalks in the driveway area) shall be removed to a "line 36 ft. north or south of the 1/2 of 2nd St. Driveways shall be reconstructed the width indicated in brackets [] on the plan between said line and the "curb to be constructed". Sidewalks shall be removed east and west to the nearest score marking beyond the driveway boundaries and replaced back to the newly constructed driveways. Commercial driveways or driveways, where the new curb face exceeds 0.67 ft. shall be removed and reconstructed back to the property line.
3. INTERSECTIONS
 - (a) Paving: All existing pavement in the area shown thus in plan shall be removed and replaced with 2 1/2" P.M.S.
 - (b) Curb & Gutter: All existing P.C.C. curb & gutter at Sierra Way and at the Alley shall be removed. At Allen St., Cuttle Dr., and Lugo Ave. the existing P.C.C. curb or curb & gutter shall be removed to the first score marking beyond the end of the "curb returns to be constructed" and reconstructed back to smoothly join the new curb returns.
 - (c) Sidewalks: All existing P.C.C. sidewalks within the "curb returns to be constructed" shall be removed back to the beginnings and endings of said curb returns. Sidewalks shall be reconstructed in sidewalk areas shown thus in plan.
4. MANHOLES
 - All manholes shall be adjusted to grade.
5. SPECIFICATIONS
 - All work embodied on these plans shall be done in conformity with applicable provisions of Specifications No. 2232.
6. LEGEND
 - D/W means Driveway
 - P.M.S. means Bituminous Plant-Mixed Surfacing
 - P.C.C. or Conc. means Portland Cement Concrete
 - M.H. means Manhole
 - WG means Water Gate

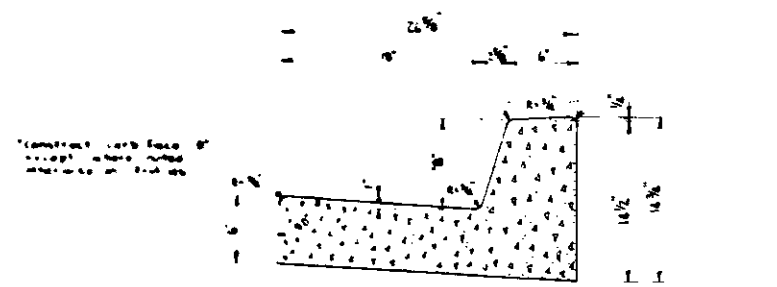

TYPICAL SECTION ~ P.C.C. CURB & GUTTER
SCALE 1 1/2" = 1'

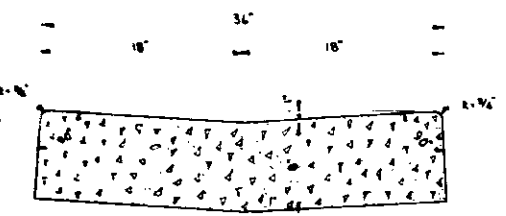

TYPICAL SECTION ~ 3' P.C.C. CROSS GUTTER
SCALE 1 1/2" = 1'

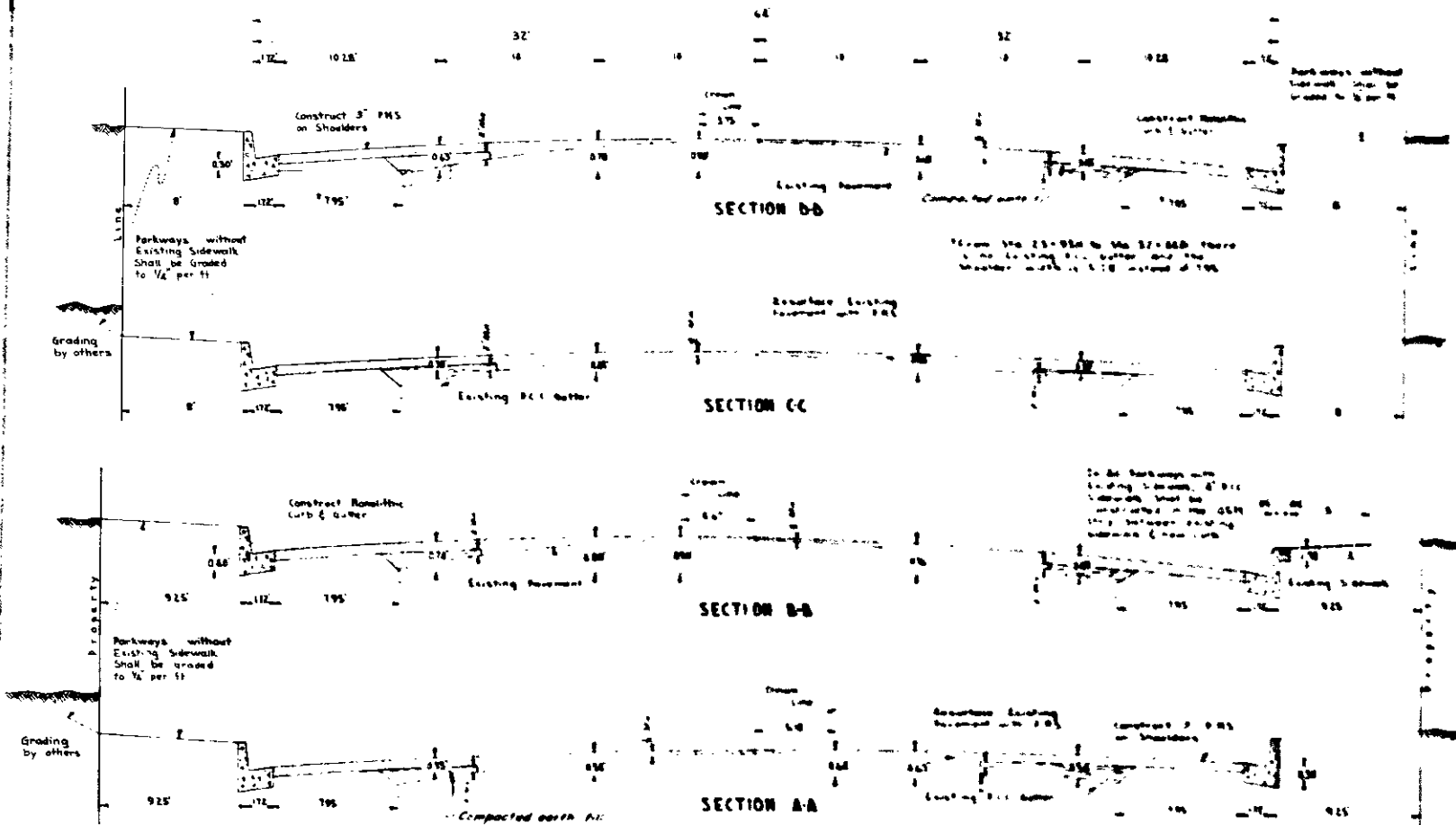

TYPICAL SECTIONS
SCALE: VERT 1/2" = 1'

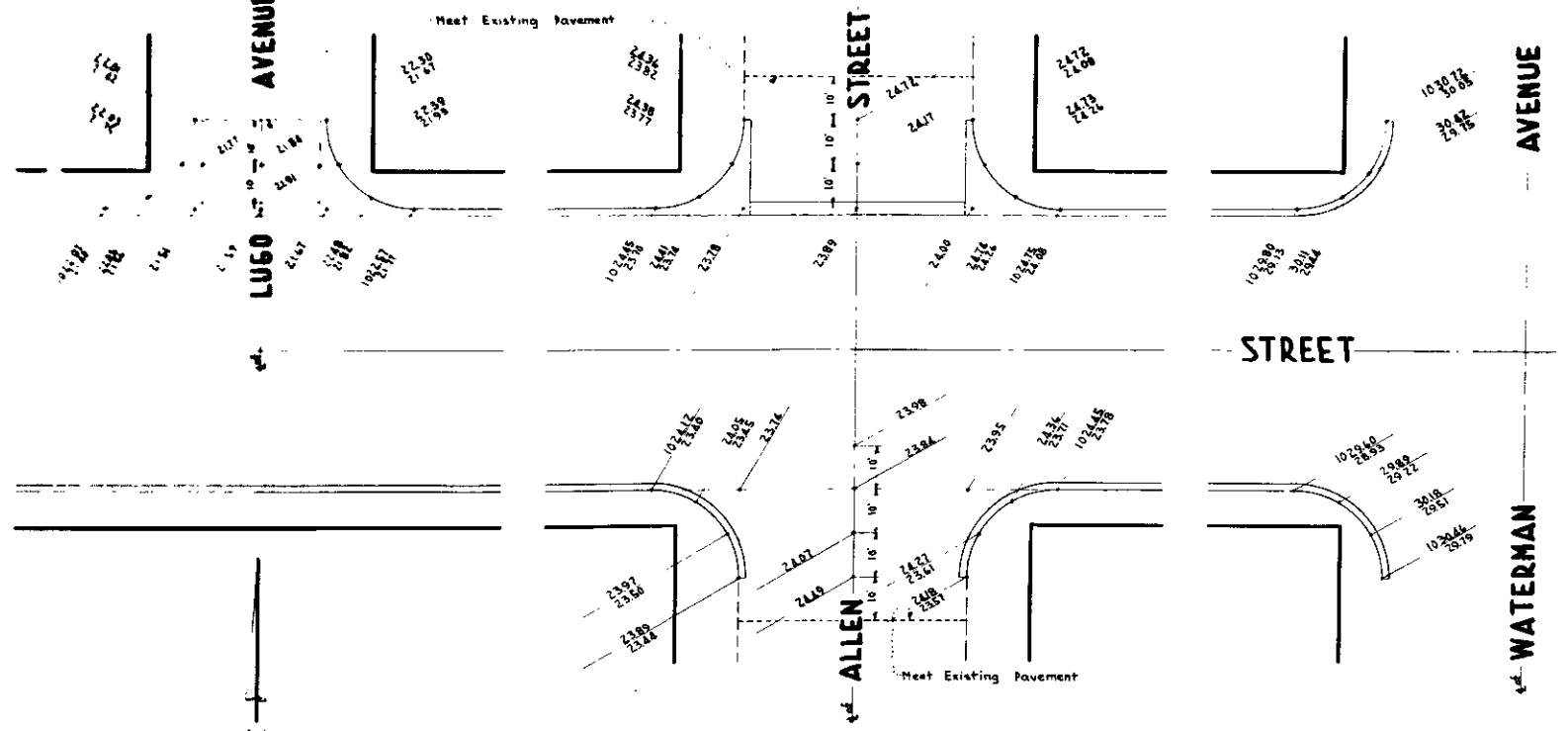
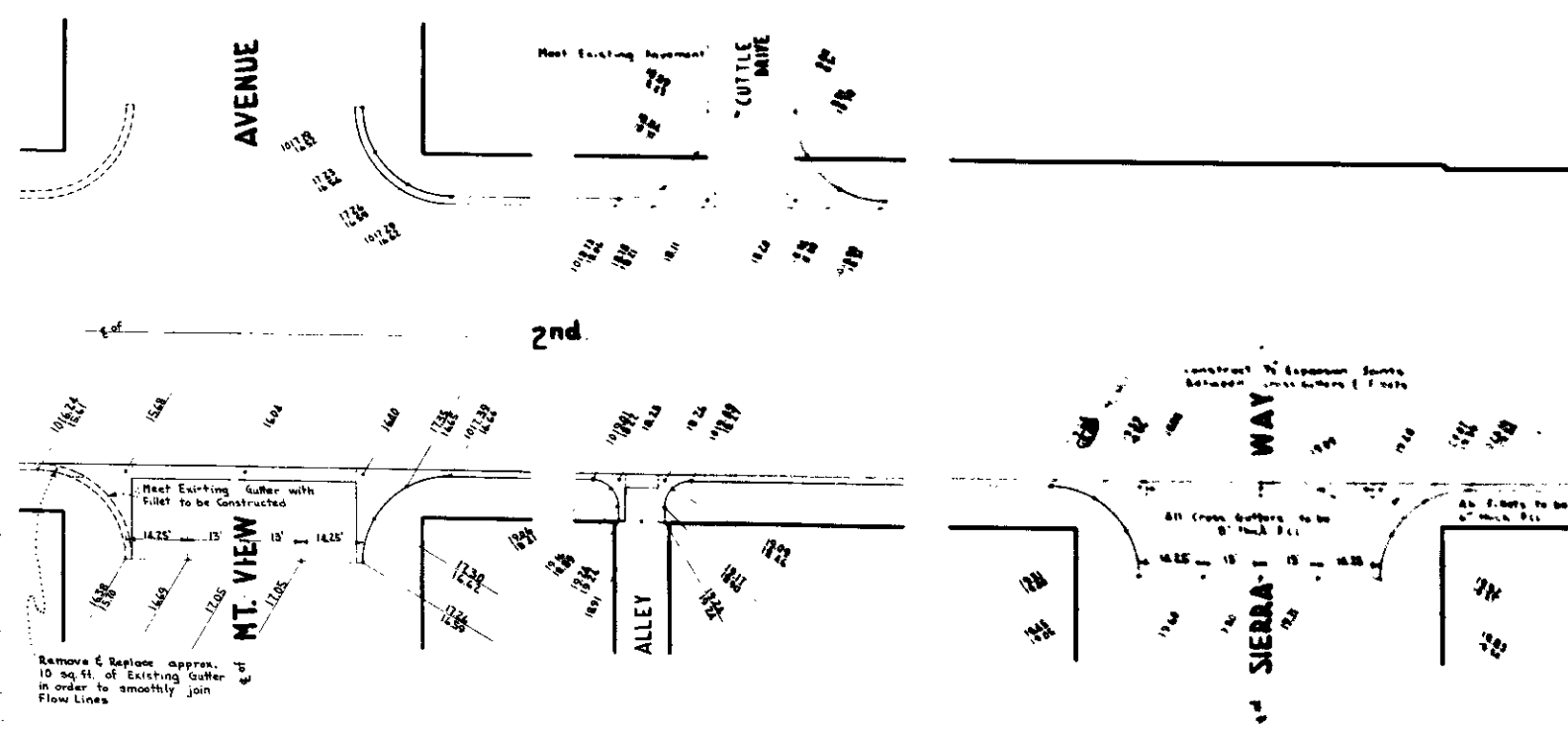

INTERSECTION LEVELS
SCALE 1" = 20'